

STEREO PROMET



INTRODUCTION

The Stereo Promet is a precision-engineered stereo zoom microscope designed for industrial inspection, biomedical research, and advanced microelectronics work.

Built on a Galileo optical system with a large 12.5:1 zoom ratio and ergonomic tilting head, it delivers sharp, true-color images with excellent depth of field while ensuring operator comfort during extended use.



DIMENSIONS

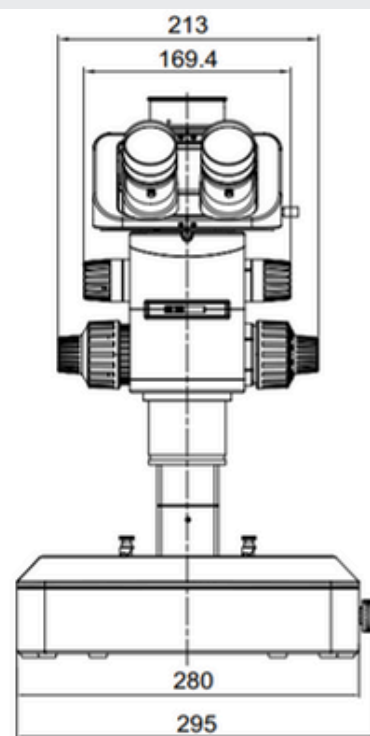
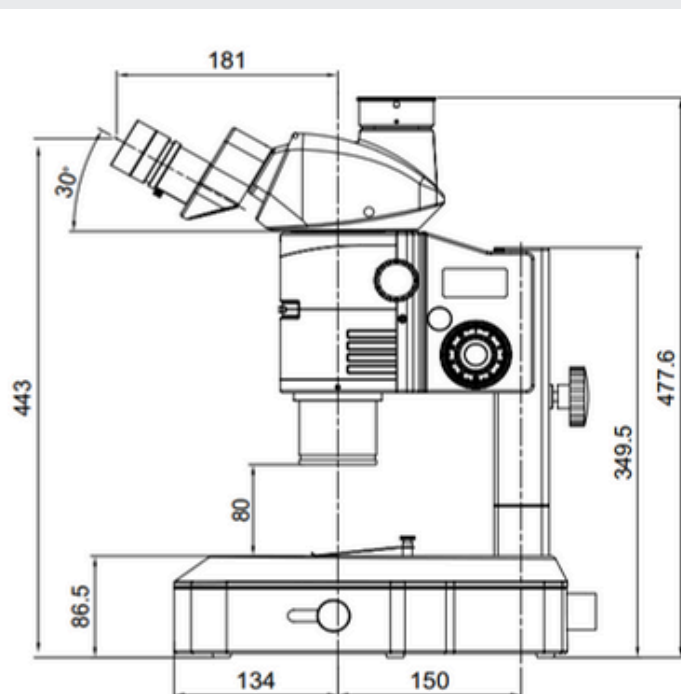

TECHNICAL SPECIFICATIONS

Category	Specification
Optical System	Galileo optical system with left & right parallel optical path
Observation Head	Trinocular head, tilt adjustable 5°–45°, vertical phototube for micro photography, diopter adjustment ring, interpupillary distance 55–75 mm
Eyepieces	Extra wide field 10X/23 mm (standard); optional 15X/16 mm, 20X/12 mm
Zoom Range & Ratio	0.63X to 8X; zoom ratio 12.5:1 with click stops
Total Magnification	6.3X to 80X with standard 10X eyepiece (higher with optional lenses)
Objectives	Apochromatic design for high color accuracy
Working Distance	110 mm standard; vertical effective movement 220 mm
Focusing System	Coaxial coarse & fine focusing mechanism; focusing range 50 mm; fine precision 0.002 mm
Base	Track stand with fan-type base, base size 330 mm × 300 mm; specimen holding clip; lateral zoom control movement
Illumination	Incident & transmitted LED system with adjustable intensity; color temperature adjustable (3000K–5600K); LCD display for brightness level
Optional Accessories	Auxiliary objectives: 0.3X, 0.5X, 0.7X, 1.5X, 2.0X; C-mount camera adapters: 0.35X, 0.5X, 1X
Standard Accessories	Operating manual, dust cover, guarantee card, styrofoam molded pack



SYSTEM DIAGRAM

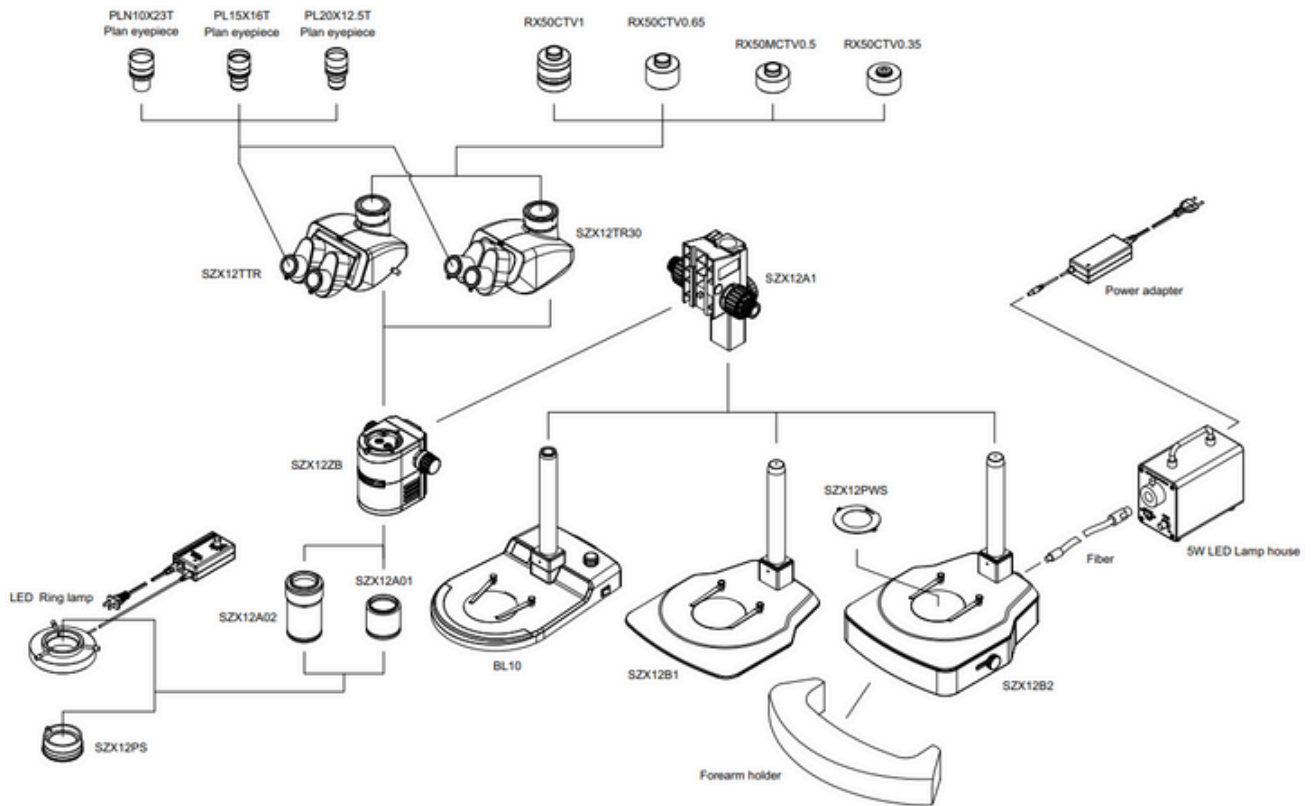

989/16/2, FIRST FLOOR, NEAR GAYATRI ICE INDUSTRIES,
MAKARPURA, VADODARA, GUJARAT - 390010



sales@ucomax.com



www.ucomax.com



+91 63588 33112